



# INV Series - General Purpose INV12-18 (12V 18Ah)

I N V E R M E X A

## Specifications

Rated Voltage	12V	
Nominal Capacity	18.0Ah	C(20),1.75V/cell
Dimension	Length	181mm (7.14 inches)
	Width	76.5mm (3.01 inches)
	Container Height	167.5mm (6.59 inches)
	Total Height	167.5mm (6.59 inches)
Approx Weight	5.35Kg (11.8lbs)	
Terminal	F5/M5	
Container Material	ABS Resin	
Rated Capacity (25°C)	18.0Ah	(20hr,0.90A,1.75V/cell)
	17.0Ah	(10hr,1.70A,1.75V/cell)
	15.5Ah	(5hr,3.10A,1.75V/cell)
	13.8Ah	(3hr,4.59A,1.75V/cell)
	11.8Ah	(1hr,11.8A,1.60V/cell)
Max. Discharge Current	230 A (5 seg)	
Internal Resistance (25°C)	Approx 16mOhms	
Operating Temp. Range	Discharge	-20~60°C (-4~140°F)
	Charge	-20~60°C (-4~140°F)
	Storage	-20~40°C (-4~104°F)
Nominal Operating Temp. Range	25°C(77°F)	
Cycle Use, load retention approx 60%	100% depth of discharge	250 cycles
	50% depth of discharge	550 cycles
Standby Use	Initial Charging Current less than 5.4A. Voltage	
	13.5V~13.8V at 25°C(77°F) Temp. Coefficient -20mV/°C	
Cycle Use	Initial Charging Current less than 5.4A. Voltage	
	14.4V~15.0V at 25°C(77°F) Temp. Coefficient -30mV/°C	
Self Discharge	INV series batteries may be stored for up to 6 months at 25°C(77°F) and then a refreshing charge is required. Self-Discharge 3% capacity declined per month at 25°C (average)	



## Layout

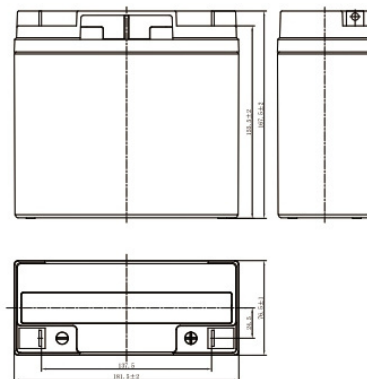

## Constant Current Discharge (Amperes) at 25°C (77°F)

F.V/Time	5min	10min	15min	20min	30min	45min	1h	1.5h	2h	3h	4h	5h	6h	8h	10h	20h
1.85V/cell	54.7	37.5	29.2	24.0	17.9	13.1	10.7	7.84	6.16	4.45	3.54	3.02	2.58	2.03	1.66	0.880
1.80V/cell	58.9	39.8	30.6	25.0	18.4	13.4	11.0	8.00	6.28	4.52	3.59	3.06	2.62	2.06	1.69	0.890
1.75V/cell	62.0	41.4	31.7	25.7	18.9	13.7	11.2	8.15	6.39	4.59	3.64	3.10	2.65	2.09	1.70	0.900
1.70V/cell	64.9	43.0	32.7	26.4	19.4	14.0	11.4	8.29	6.48	4.66	3.69	3.14	2.68	2.11	1.72	0.907
1.67V/cell	67.2	44.2	33.5	27.0	19.7	14.2	11.6	8.40	6.56	4.70	3.73	3.17	2.71	2.12	1.73	0.914
1.60V/cell	71.3	46.1	34.7	27.8	20.3	14.6	11.8	8.58	6.69	4.79	3.79	3.22	2.75	2.15	1.75	0.924

## Constant Power Discharge (Watts/cell) at 25°C (77°F)

F.V/Time	5min	10min	15min	20min	30min	45min	1h	1.5h	2h	3h	4h	5h	6h	8h	10h	20h
1.85V/cell	103.5	71.4	55.9	46.3	34.6	25.4	20.8	15.3	12.1	8.74	6.98	5.95	5.11	4.03	3.31	1.76
1.80V/cell	110.3	75.2	58.3	47.9	35.5	25.9	21.3	15.6	12.3	8.87	7.07	6.03	5.18	4.09	3.35	1.78
1.75V/cell	114.9	77.6	59.9	48.9	36.2	26.4	21.6	15.8	12.4	8.98	7.16	6.10	5.23	4.13	3.38	1.80
1.70V/cell	119.2	80.2	61.5	50.1	37.0	26.9	21.9	16.1	12.6	9.10	7.24	6.17	5.29	4.17	3.41	1.81
1.67V/cell	122.3	82.0	62.8	51.0	37.5	27.3	22.2	16.2	12.7	9.18	7.30	6.22	5.33	4.20	3.43	1.83
1.60V/cell	127.2	84.4	64.5	52.3	38.4	27.8	22.6	16.5	12.9	9.32	7.41	6.30	5.40	4.25	3.47	1.85



# INV Series - General Purpose INV12-18 (12V 18Ah)

I N V E R M E X A

## Applications

- All purpose
- Uninterruptable Power Supply (UPS)
- Electric Power System (EPS)
- Emergency backup power supply
- Alarm and security system
- Communication power supply
- DC power supply
- Auto control system

## General Features

- 5 years design life (25°C)
- Special oneway valves allow the gases to scape thus avoiding excessive pressure build-up
- Special exhaust structure and sealing technology, safe and reliable, flexible instalation, sealed construction, maintenance-free, leak proof, usable in any position.
- PbCaSn alloy for plate grids: less gassing, les self-discharging
- High quality AGM Technology separator extend cycle life and prevent micro short circuit.
- High purity raw material: ensure low self discharge rate

## Standards

- Compliance with IEC 60896 standards, EU Battery Directive.
- UL94 HB, CE Certified
- Manufactured by VN Center Power Tech Co.Ltd. under ISO45001, ISO 9001 and ISO 14001 certified production facilities
- Not restricted for air transport-complies with IATA/ICAO Special Provision A67

## Discharge Characteristics

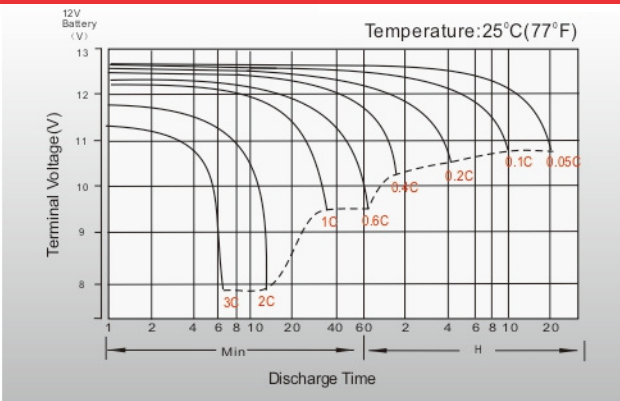

## Float Charging Characteristics

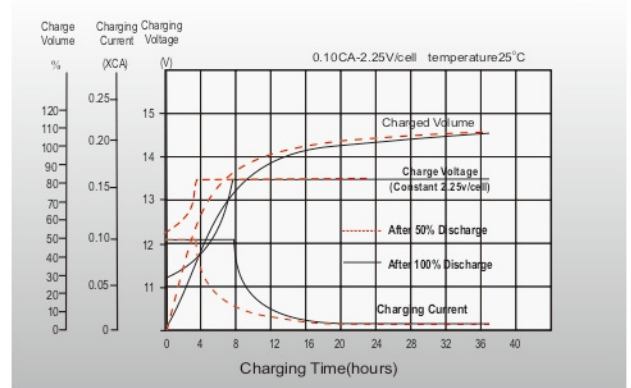

## Temperature Effects in Relation to Battery Capacity

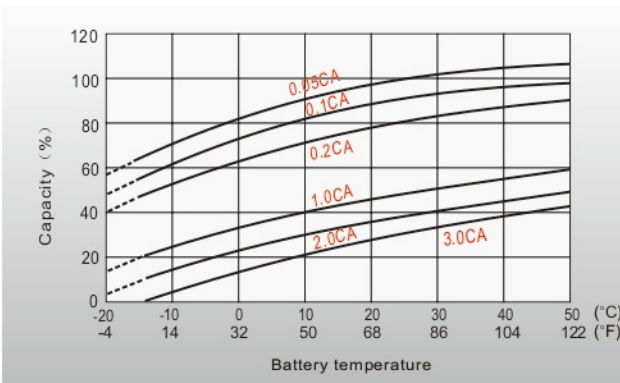

## Effect of Temperature on Long Term Float Life

