



INV Series - General Purpose

INV12-26 (12V 26Ah)

I N V E R M E X A

Specifications

Rated Voltage	12V	
Nominal Capacity	26.0Ah	C(20),1.75V/cell
Dimension	Length	166mm (6.54 inches)
	Width	175mm (6.93 inches)
	Container Height	125mm (4.92 inches)
	Total Height	125mm (4.92 inches)
Approx Weight	7.68Kg (16.9lbs)	
Terminal	F5/M5	
Container Material	ABS	
Rated Capacity (25°C)	26.0Ah	(20hr,1.30A,1.75V/cell)
	24.6Ah	(10hr,2.46A,1.75V/cell)
	22.15Ah	(5hr,4.43A,1.70V/cell)
	16.1Ah	(1hr,16.1A,1.60V/cell)
	12.9 Ah	(15min,51.1A,1.85V/cell)
Max. Discharge Current	390A (5s)	
Internal Resistance (25°C)	Approx 11mOhms	
Operating Temp. Range	Discharge	-40~60°C (-40~140°F)
	Charge	-20~60°C (-4~140°F)
	Storage	-20~60°C (-4~140°F)
Nominal Operating Temp. Range	25°C(77°F)	
Cycle Use	Initial Charging Current less than 7.8A. Voltage	
	14.4V~15.0V at 25°C(77°F) Temp. Coefficient -30mV/°C	
Standby Use	Initial Charging Current less than 7.8A. Voltage	
	13.4V~13.8V at 25°C(77°F) Temp. Coefficient -20mV/°C	
Effect of Temp. to Capacity	40°C (104°F)	103%
	25°C (77°F)	100%
	0°C (32°F)	86%
Self Discharge	INV series batteries may be stored for up to 6 months at 25° C(77°F) and then a freshening charge is required. Self-Discharge 3% of capacity declined per month at 25° C (average).	



Layout

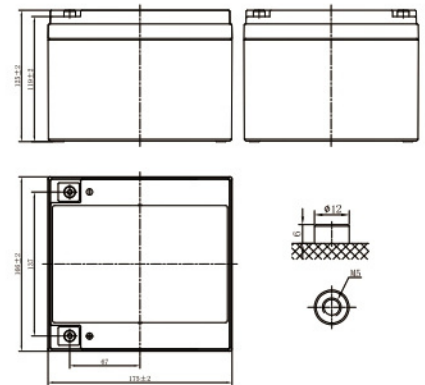

Constant Current Discharge (Amperes) at 25°C (77°F)

F.V/Time	5min	10min	15min	20min	30min	45min	1h	1.5h	2h	3h	4h	5h	6h	8h	10h	20h
1.85V/cell	69.9	51.1	38.8	33.1	24.8	18.2	14.5	10.8	8.56	6.18	4.92	4.25	3.64	2.87	2.40	1.27
1.80V/cell	75.1	54.2	40.7	34.4	25.6	18.7	14.8	11.0	8.72	6.28	5.00	4.31	3.70	2.91	2.44	1.29
1.75V/cell	79.2	56.3	42.0	35.3	26.2	19.1	15.1	11.2	8.88	6.38	5.06	4.37	3.74	2.94	2.46	1.30
1.70V/cell	82.9	58.6	43.4	36.4	26.9	19.5	15.4	11.4	9.01	6.47	5.13	4.43	3.78	2.97	2.48	1.31
1.67V/cell	85.8	60.3	44.5	37.1	27.4	19.8	15.6	11.6	9.11	6.54	5.18	4.46	3.82	2.99	2.50	1.32
1.60V/cell	91.0	62.8	46.0	38.2	28.1	20.3	16.0	11.8	9.29	6.66	5.27	4.54	3.87	3.04	2.53	1.34

Constant Power Discharge (Watts/cell) at 25°C (77°F)

F.V/Time	5min	10min	15min	20min	30min	45min	1h	1.5h	2h	3h	4h	5h	6h	8h	10h	20h
1.85V/cell	132.2	97.3	74.2	63.7	47.9	35.2	28.2	21.1	16.8	12.1	9.70	8.39	7.20	5.68	4.77	2.54
1.80V/cell	140.8	102.4	77.4	65.9	49.2	36.1	28.8	21.4	17.0	12.3	9.82	8.50	7.30	5.76	4.84	2.57
1.75V/cell	146.7	105.7	79.5	67.3	50.3	36.7	29.2	21.8	17.3	12.5	9.94	8.60	7.38	5.82	4.88	2.60
1.70V/cell	152.1	109.2	81.7	68.9	51.3	37.4	29.7	22.1	17.5	12.6	10.1	8.70	7.45	5.87	4.93	2.62
1.67V/cell	156.1	111.7	83.4	70.2	52.1	37.9	30.1	22.3	17.7	12.8	10.1	8.76	7.52	5.92	4.96	2.64
1.60V/cell	162.4	114.9	85.7	71.9	53.2	38.6	30.6	22.7	18.0	13.0	10.3	8.88	7.61	5.99	5.02	2.67



INVSeries - General Purpose

INV12-26 (12V 26Ah)

I N V E R M E X A

Applications

- All purpose
- Uninterruptable Power Supply (UPS)
- Electric Power System (EPS)
- Emergency backup power supply
- Alarm and security system
- Communication power supply
- DC power supply
- Auto control system

General Features

- 5 years design life (25°C)
- Special oneway valves allow the gases to scape thus avoiding excessive pressure build-up.
- Special exhaust structure and sealing technology, safe and reliable, flexible instalation, sealed construction, maintenance-free, leak proof, usable in any position.
- PbCaSn alloy for plate grids: less gassing, les self-discharging
- High quality AGM Technology separator extend cycle life and prevent micro short circuit.

Standards

- Compliance with IEC 60896 standards, EU Battery Directive.
- UL94 HB, CE Certified
- Manufactured by VN Center Power Tech Co.Ltd. under ISO45001, ISO 9001 and ISO 14001 certified production facilities
- Not restricted for air transport-complies with IATA/ICAO Special Provision A67

Discharge Characteristics

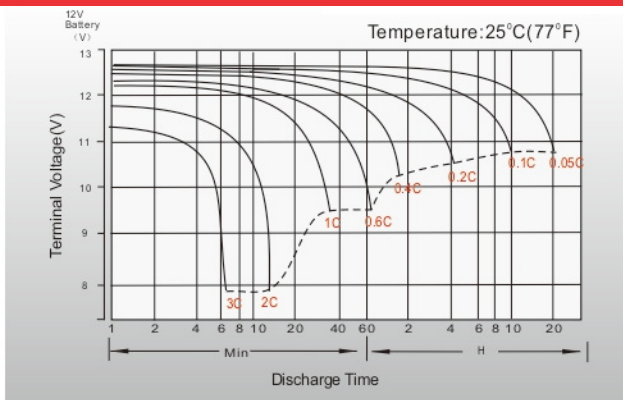

Float Charging Characteristics

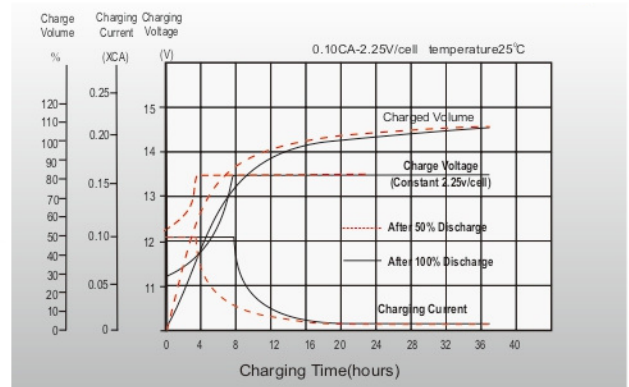

Temperature Effects in Relation to Battery Capacity

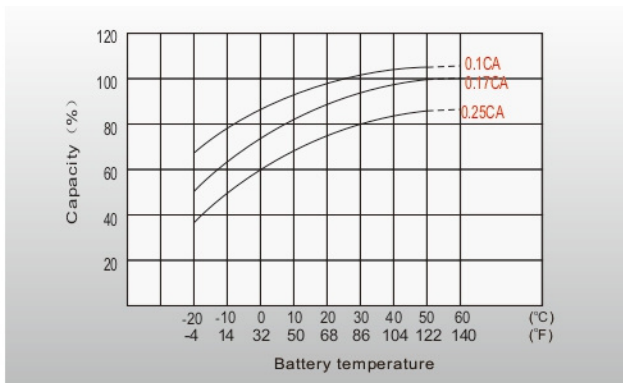

Effect of Temperature on Long Term Float Life

