



INVL Series-Long Life

INVL12-38 (12V 38Ah)

INVERMEXA

Performance Characteristics

Nominal Voltage	12V
Number of cell	6
Design Life	10 years
Nominal Operating Temperature 25°C	
• 20 hour rate (2.00A, 10.8V)	40.0Ah
• 10 hour rate (3.80A, 10.8V)	38.0Ah
• 5 hour rate (6.92A, 10.5V)	34.6Ah
• 1 hour rate (24.2A, 9.6V)	24.2Ah
Internal Resistance	<8mOhms
• Fully Charged Battery 25°C	
Self-Discharge	
• 3% of capacity declined per month at 20°C	
Operating Temperature Range	
• Discharge	-20~60°C
• Charge	-10~60°C
• Storage	-20~60°C
Max. Discharge Current 25°C	800A (5s)
Short Circuit	850A
Current Charge Methods: Float Charge Voltage 25°C	13.5-13.8VDC
• Cycle use	
• Maximum Charging Current	9.9A
• Temperature compensation	-30mV/°C
• Standby use	2.20-2.28VPC
• Temperature compensation	-20mV/°C
Dimensions and Weight	
• Length (mm/inch)	197 / 7.76
• Width (mm/inch)	165 / 6.50
• Height (mm/inch)	175 / 6.88
• Total Height (mm/inch)	175 / 6.88
• Approx. Weight (Kg/lbs)*	13.0 / 28.6
Terminal	Faston F11(M6)



Layout

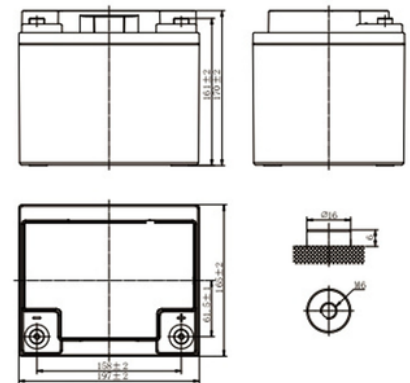

Discharge Constant Current (Amperes at 77°F 25°C)

End Point Volts/Cell	10min	15min	30 min	1 h	3 h	5 h	10 h	20 h
1.60V	78.7	67.4	40.0	24.2	10.9	7.27	3.97	2.08
1.65V	76.1	65.4	39.4	23.9	10.8	7.17	3.93	2.06
1.70V	73.8	63.5	38.8	23.5	10.7	7.03	3.88	2.03
1.75V	69.2	59.8	38.1	23.1	10.5	6.92	3.84	2.01
1.80V	63.8	55.2	37.3	22.0	10.3	6.79	3.80	2.00

Discharge Constant Power (Watts at 77°F 25°C)

End Point Volts/Cell	10min	15min	30min	45min	1 h	2 h	3 h	5 h
1.60V	136	119.4	73.3	53.7	45.6	28.0	20.9	14.1
1.65V	134	117.7	73.0	53.4	45.2	27.8	20.8	13.9
1.70V	132	115.8	72.5	52.9	44.8	27.5	20.7	13.7
1.75V	126	110.2	71.6	52.2	44.2	27.1	20.4	13.5
1.80V	118.3	103.02	70.7	50.7	42.3	25.9	20.0	13.3



INVL Series-Long Life

INVL12-38 (12V 38Ah)

INVERMEXA

General features

- Absorbent Glass Mat (AGM) technology for efficient gas recombination of up to 99% and freedom from electrolyte maintenance or water adding.
- Not restricted for air transport-complies with IATA/ICAO Special Provision A67.
- UL-recognized component.
- Can be mounted in any orientation.
- Computer designed lead, calcium tin alloy grid for high power density.
- Long service life, float or cyclic applications.
- Maintenance-free operation.
- Low self discharge.

Standards

- Compliance with IEC 60896 standards, EU Battery Directive.
- UL1989, UL94HB.
- CE Certified.
- Manufactured under ISO45001, ISO9001 and ISO14001 certified production facilities.

Applications

- All purpose.
- Uninterruptable Power Supply (UPS).
- Electric Power System (EPS).
- Emergency backup power supply.
- Alarm and security system.
- Communication power supply.
- DC power supply.
- Auto control system.

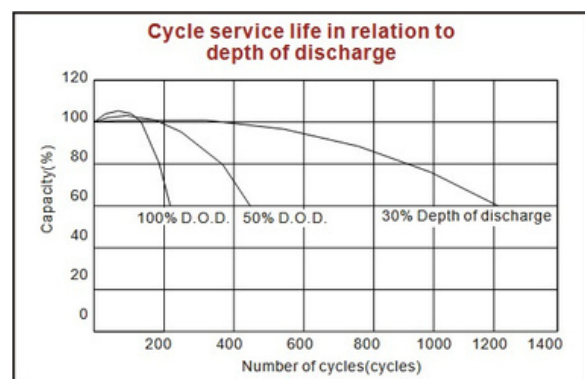
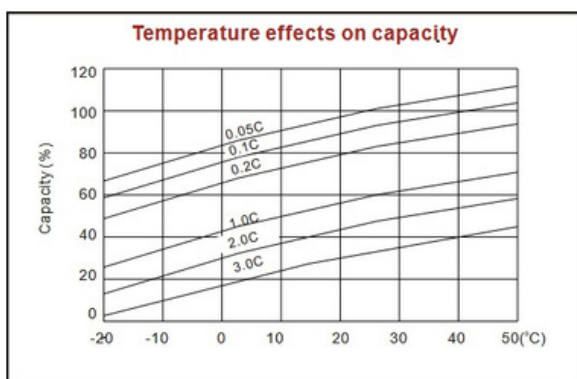
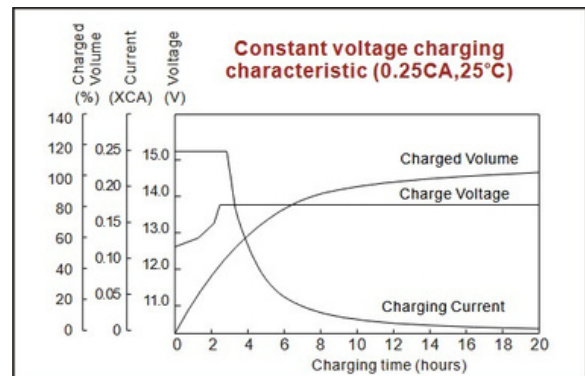
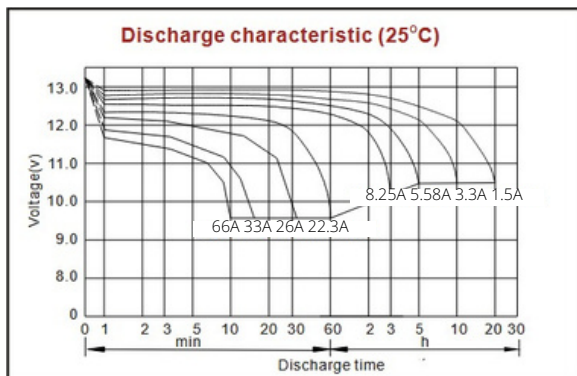

- 225 cycles @ 100% D.O.D.
- 450 cycles @ 50% D.O.D.
- 1200 cycles @ 30% D.O.D.